

F1 HYLDEREOL

(GB) INSTALLATION INSTRUCTIONS

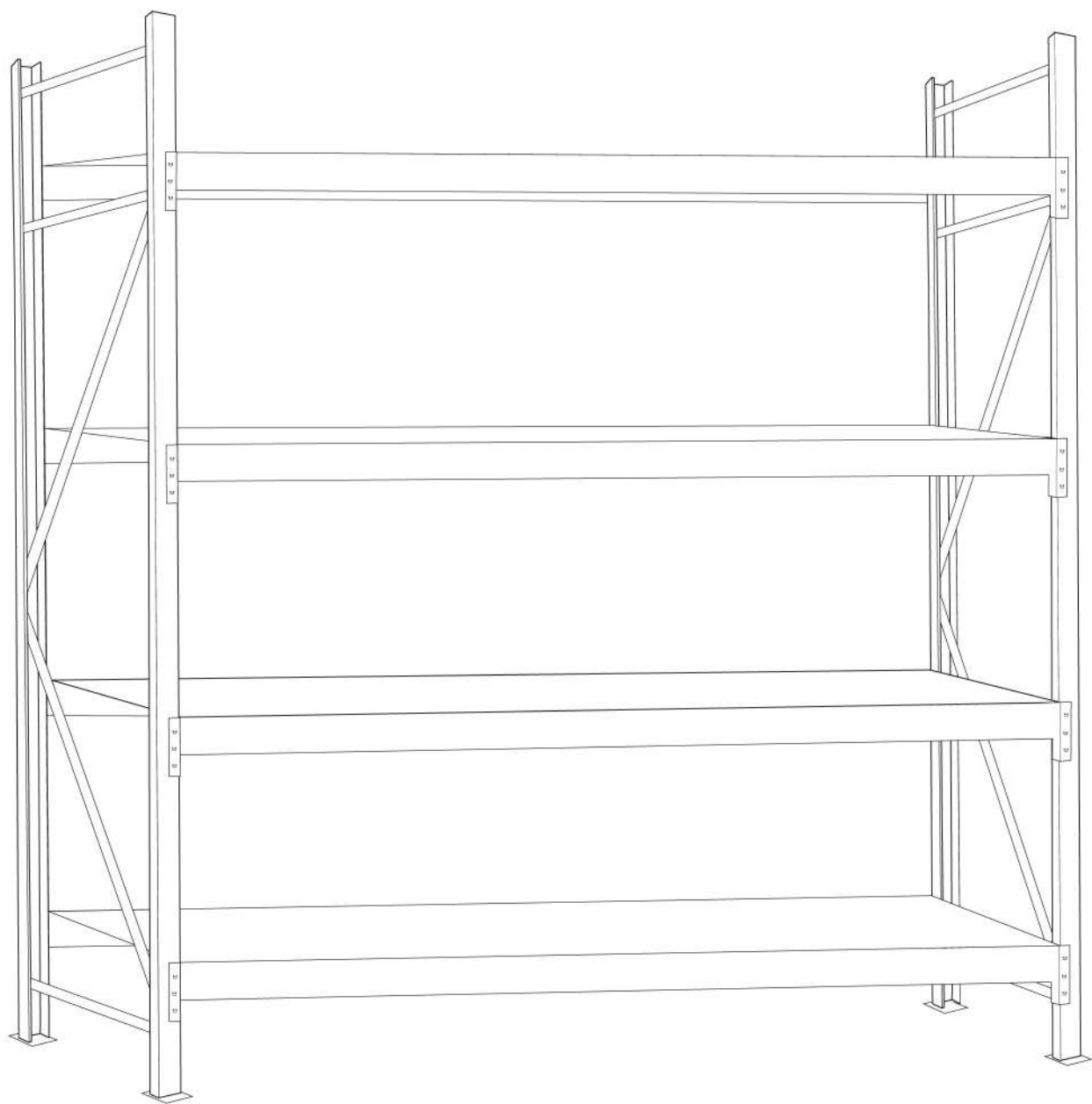



1

Place the first upright up against the wall.



2

Mount the first beam approx. 40 cm above the floor.



??

3

Safety clip is pressed in place.

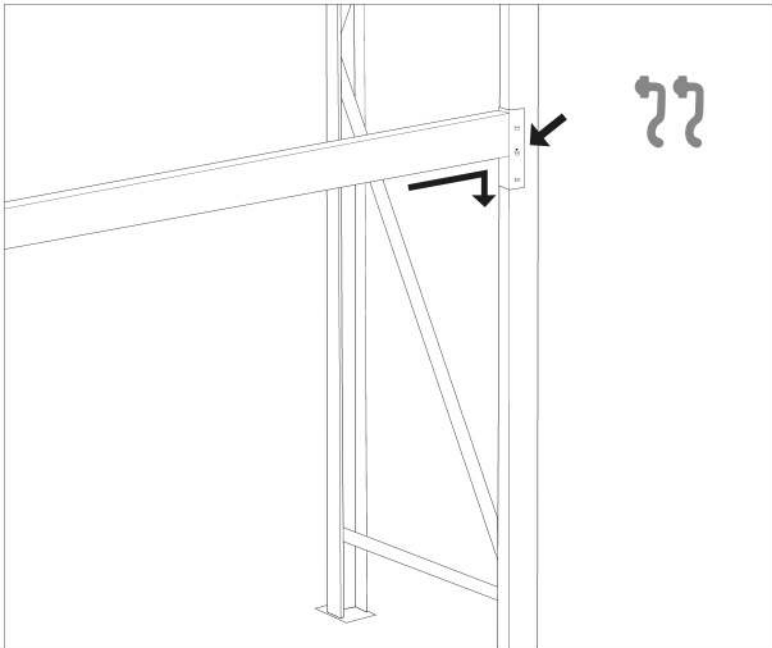

4

The beam is mounted to the next upright.

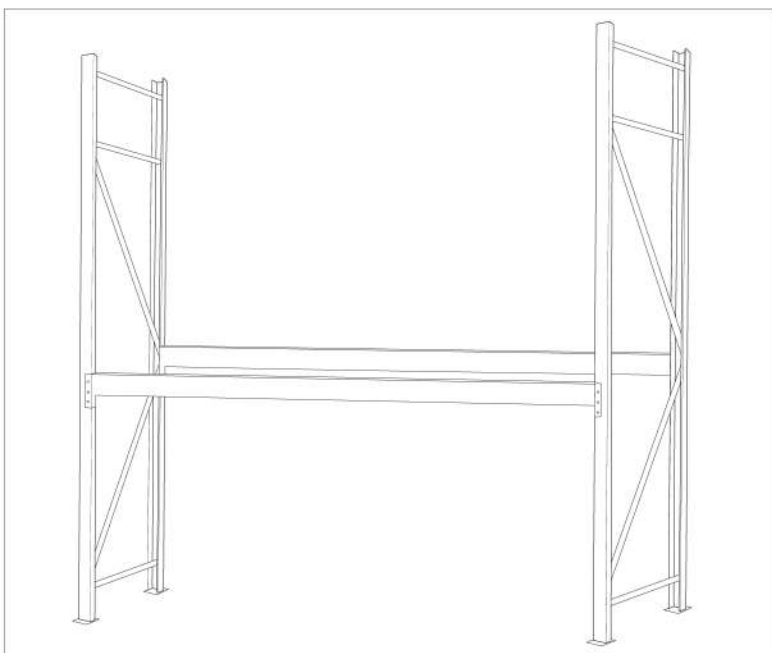

5

The second beam is mounted, and then repeat the process.

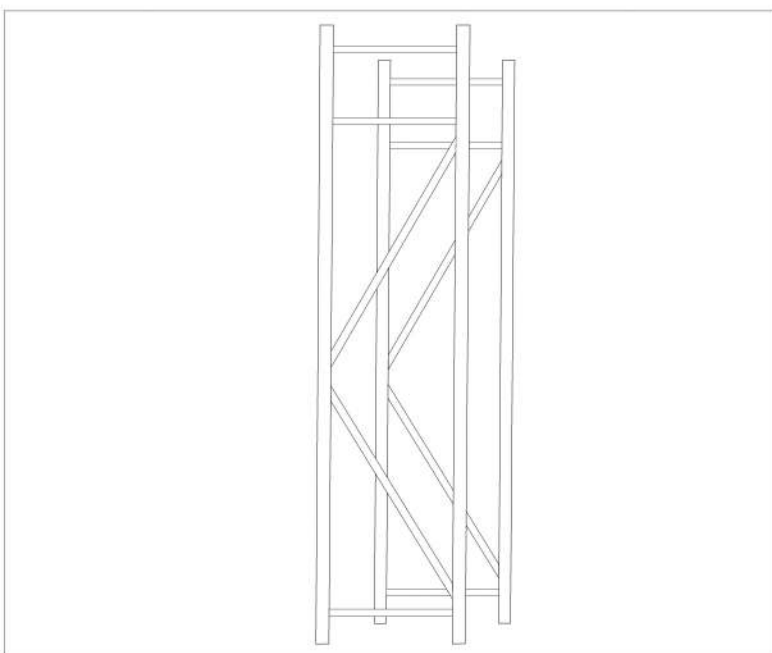

6

It is recommended that the uprights are placed symmetrically.

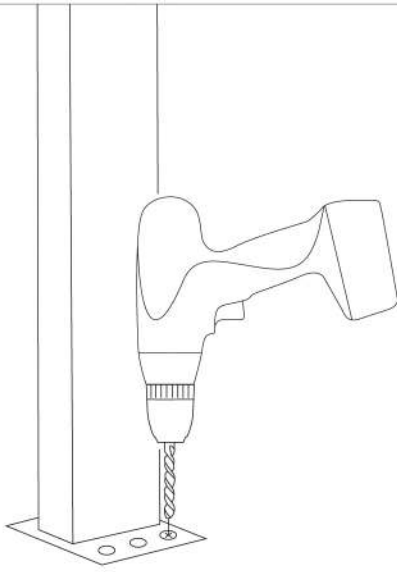

After the mounting is completed, the uprights are adjusted and secured with anchor bolts.

BELASTNINGSOVERSIGT

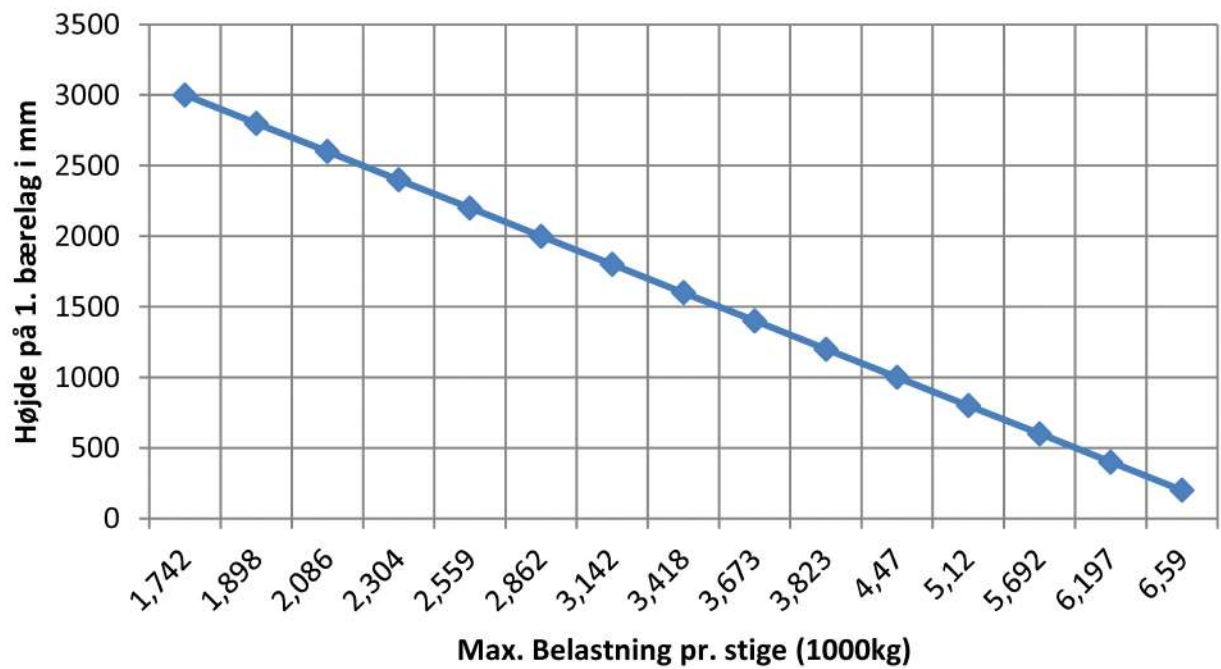

Herover: Belastningsdiagram der viser højden på 1. bærelag kontra max. belastning pr sektion.

IMPORTANT! assumes no responsibility for defects or damage due to carelessness and improper use.